

15. BEARING UNITS AND BEARING HOUSINGS

15.2. Cast-iron bearings units with insert ball bearings – type – UCPA

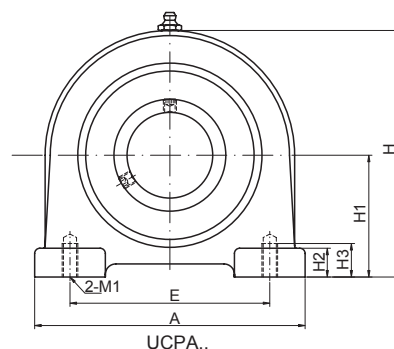









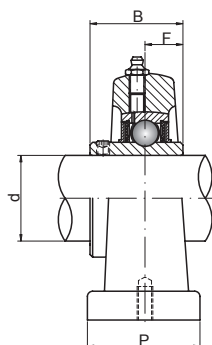





12 – 65 mm



Shaft [mm]	Unit No.	Dimensions [mm]											
		d	H1	A	E	P	bolt size	H3	H2	H	B	F	bolt size
12	UCPA201	12	30,2	76	52	40	M10	15	11	62	31	12,7	M10
15	UCPA202	15	30,2	76	52	40	M10	15	11	62	31	12,7	M10
17	UCPA203	17	30,2	76	52	40	M10	15	11	62	31	12,7	M10
20	UCPA204	20	30,2	76	52	40	M10	15	11	62	31	12,7	M10
25	UCPA205	25	36,5	84	56	38	M10	15	12	72	34,1	14,3	M10
30	UCPA206	30	42,9	94	66	50	M14	18	12	84	38,1	15,9	M14
35	UCPA207	35	47,6	110	80	55	M14	20	13	95	42,9	17,5	M14
40	UCPA208	40	49,2	116	84	58	M14	20	13	100	49,2	19	M14
45	UCPA209	45	54,2	120	90	60	M14	25	13	108	49,2	19	M14
50	UCPA210	50	57,2	130	94	64	M16	25	14	116	51,6	19	M16
55	UCPA211	55	63,5	140	104	66	M16	25	14	125	55,6	22,2	M16
60	UCPA212	60	69,9	150	114	68	M16	25	15	138	65,1	25,4	M16
65	UCPA213	65	76,2	160	124	70	M16	25	15	150	65,1	25,4	M16

- warehouse - order - phone



Weight [kg]	Composition		Basic makes*	Unit No.
	bearing	housing		
0,6	UC201	PA204		UCPA201
0,59	UC202	PA204		UCPA202
0,58	UC203	PA204		UCPA203
0,56	UC204	PA204		UCPA204
0,83	UC205	PA205		UCPA205
1,12	UC206	PA206		UCPA206
1,48	UC207	PA207		UCPA207
1,89	UC208	PA208		UCPA208
1,98	UC209	PA209		UCPA209
2,16	UC210	PA210		UCPA210
3,26	UC211	PA211		UCPA211
4,19	UC212	PA212		UCPA212
5,23	UC213	PA213		UCPA213

* Other products also available

